

strategy evolution

DISCOVER

Leader's Handbook

2026 | Version 1

WELCOME

Welcome to Discover! We are super excited to welcome you our newest member of the S&E family.

The location for our activities is Cirencester Park, with the event taking place within the S&E campsite.

This booklet is designed to provide you with the information that you will need before, during and after the event. If there are any questions before the event speak to your group's leader or email us on admin@s-e.org.uk. For any questions at the event; ask someone wearing a helpers lanyard, wearing a S&E hi-vis, someone who is wearing a yellow S&E necker, or pop into the Admin tent.

Got a question?

Before the event: email admin@s-e.org.uk or speak to your group leader.

On site: look for a S&E hi-vis, a yellow S&E necker, or pop into the Admin tent.

CONTENTS

Welcome	2
Getting to site	4
Facilities	5
Kit list	6
Food	7
Programme & Timings	8
Main event	10
Health & safety	11
Leaving site	13
Useful contacts	14

GETTING TO SITE

Cirencester Park

Cirencester Park, Cirencester, Gloucestershire, GL7 7HX

what3words: ///scaffold.snores.defers

Please follow the Strategy and Evolution waymarked route – this will lead you to approach from the Stroud Road.

No access via Daglingworth

There is no access to Strategy and Evolution through the village of Daglingworth.

On arrival at the site there will be a one-way system in operation. Please follow the signs and directions of the marshals. There may be queues when arriving or leaving the site we welcome your patience during this time. Exit from site is a left turn only.

Please note there may be the need for us to stop traffic for the safety of the young people on site. At this time no vehicles will be able to move. We welcome your patience during these times.

No dogs on site

No dogs are allowed on site. This includes drop-off and pick-up.

On site

You will be to access the site from 9am. Please be aware the site is already open to our sister event Evolution, so access will not be permitted before this.

Prior to arrival, you will be given a wristband colour (wristbands will be given at admin). Please let your young people know which colour they will be. When they arrive, they will meet you at the flag which matches their wristband colour.

Once you are on site, you will be unable to access the car park so please ensure you bring everything with you.

A leader from each group will need to head to admin to receive your groups pack.

FACILITIES

The Café and tuck shop

Please note: whilst we take every care to reduce the risk of cross contamination, the Strategy and Evolution Café is unable to guarantee a completely allergen free environment as food containing allergens are prepared within the café.

Toilets

The toilet doors are spring loaded and your young people may need support opening these. We do have accessible toilets available please speak to a helper if you need access. We encourage the use of groups when attending the toilets.

Chill Tent

During the weekend the chill tent is available as a quieter space on site for both adults and young people. It's an area to wind down and relax with access to our inclusion team to talk to about any worries or issues you may have. Please be aware young people need to be accompanied by a leader. The team are also there to talk through any inclusion queries that leaders may have.

Shop

There will be loads of S&E branded items to buy from pens and badges to neckers and t-shirts. So don't forget a bit of spending money! You can see a selection and pre-order online at shop.s-e.org.uk. Pre-ordering ensures the items you want are available as we often sell-out of popular sizes and colours. Pre-ordering will also give you the chance to personalise items. Any items pre-ordered can be picked up from the Shop – opening times will be displayed outside.

Coffee Van

We recognise that it's an early start to the day, so in the morning they'll be a coffee van selling a variety of teas, coffees and small snacks in the car park.

KIT LIST

Personal kit – leaders	Personal kit – participants
packed lunch (we are a nut free site)	packed lunch (we are a nut free site)
water bottle	water bottle
thermos cup	bag to carry home crafts
collapsible chair	weather appropriate clothing
first aid kit	group necker
weather appropriate clothing	–
group necker	–
a pen to write names on passports	–

FOOD

You need to bring a packed lunch with you, please note we are a nut free site. Please take your rubbish home.

There are drinking water and hot drink facilities available throughout the event. Free hot drinks can be obtained from the tent near the Air zone

*If you are on site for Evolution, please collect your packed lunch as usual.

PROGRAMME & TIMINGS

The day runs to a science-zones rotation. Use the table below to find your group's order through Air, Earth, Sun and Water.

Key timings

ARRIVAL	DAY	DEPARTURE
9.00am – site access (no earlier) Meet at your wristband-colour flag	9.45am – opening ceremony Activities across four Science zones 3.10pm - closing ceremony	3.30pm – pick up opens 4.30pm – all attendees off site

Programme schedule

Each wristband group rotates through the four seasonal zones across the day.

Wristband	10.05 – 11.10am	11.10 – 12.15pm	12.15 – 1.00pm	1.00 – 2.05pm	2.05 – 3.10pm
Pink	Air	Earth	Lunch	Water	Sun
Blue	Earth	Water	Lunch	Sun	Air
Orange	Water	Sun	Lunch	Air	Earth
Gold	Sun	Air	Lunch	Earth	Water

MAIN EVENT

All attendees will be put into groups of around 75-100 young people (and their adults). Your Drey, Unit or Colony will be kept together.

When you hear a Klaxon / "Bing-bong" sound, groups will follow someone with a coloured flag to the next zone, the flag will match the colour on your wristbands. Please don't leave the programme zone until advised.

There will be a number of activities in each zone, including: Team games, Individual activities, Experiments, Quiet activities and crafts.

You'll be given a Discover passport for every young person to fill in as they go round. This will help you know what activities they have done, and therefore what badge requirements they have fulfilled. Please encourage all of your young people to do as many activities as possible. There are over 40 activities planned, so please recognise your young people may not get to do all of them.

After the event, you'll have access to a guide showing what badge or award requirements have been completed by taking part in different activities.

There will be an adult at every activity to support, you may at times be needed to help your young people with some of the activities (e.g. cutting things out and encouraging taking turns and good sharing).

At lunchtime, there will be plenty of space for you to eat lunch with your group, whether that is under shade or in the open. In the event of wet weather some activities may not be available, and many will move into tents.

Programme zones will include a visit to a Tuck shop and the on-site shop for merchandise. Card and contactless is accepted, young people are encouraged to bring small change if wanted.

New for 2026, we will have an activity with Reptiles and minibeasts, if you or any person has a Nut allergy, please make the team aware when you take part in this activity.

HEALTH & SAFETY

Site phone (emergencies only)

01285 505 404

Each group must have its own emergency contact, please let your group know who this is.

First aid

In the first instance, leaders are responsible for first aid. If required, there is a medical team on site for more serious injuries.

Risk assessments

All RA's will be available on our website, under the downloads section.

Missing person

In the event of a missing person, please make your way to the admin tent. Here we will take down some key details. We will then ask you to go back out and continue looking. If you find the young person please come and let us know. If after 10 minutes you have not found them please return to admin.

Insect & tick bites

Due to the events taking place in fields and woodland there is the risk of being bitten or stung by insects including horseflies, wasps and ticks. It is important to be aware of ticks and to safely remove them as soon as possible, just in case.

We recommend bringing insect repellent and insect bite creams/clickers & antihistamines as part of your first aid kit.

- To reduce the risk of being bitten:
- Cover your skin while walking outdoors and tuck your trousers into your socks.
- Use insect repellent on your clothes and skin.
- Stick to paths whenever possible.
- Wear light-coloured clothing so ticks are easier to spot and brush off.

To remove a tick safely

You don't need to do anything else unless you become unwell.

See a GP if you've been bitten by a tick and you get flu-like symptoms (such as feeling hot and shivery, headaches, aching muscles or feeling sick) or a circular red rash. Always remember to tell them you've been in forests and grassy areas.

1. Use fine-tipped tweezers or a tick-removal tool.
2. Grasp the tick as close to the skin as possible.
3. Slowly pull upwards, taking care not to squeeze or crush the tick.
4. Clean the bite with antiseptic or soap and water.

Wristbands

Everyone on site must have a S&E wristband. Leaders should challenge people without one, and escort them to admin. If you feel unable to challenge somebody, please ask an S&E volunteer.

LEAVING SITE

Cirencester Park

Cirencester Park, Cirencester, Gloucestershire, GL7 7HX

what3words: ///scaffold.snores.defers

Collection

The route into the site will be the same as when parents or carers drop off in the morning.

Please be aware that as we are running a one-way system, there may be queues as you leave site. Please ensure you are following the signed speed limits of the site. We appreciate your patience with this matter.

Pick up will be from 3.30pm - please do not arrive before 3.15pm.

No exit during Evolution walk backs

During the walk backs for our sister event, Evolution, the exit from our car park will be closed. It will not be possible to leave the site until the walk back is completed

All event attendees must have left site by 4.30pm.

USEFUL CONTACTS

Save the details below to your phone before you travel. Email is checked daily in the run-up to the event.

Email	admin@s-e.org.uk
Site phone	01285 505 404 (emergencies only)
Website	s-e.org.uk
Shop	shop.s-e.org.uk

Site Map

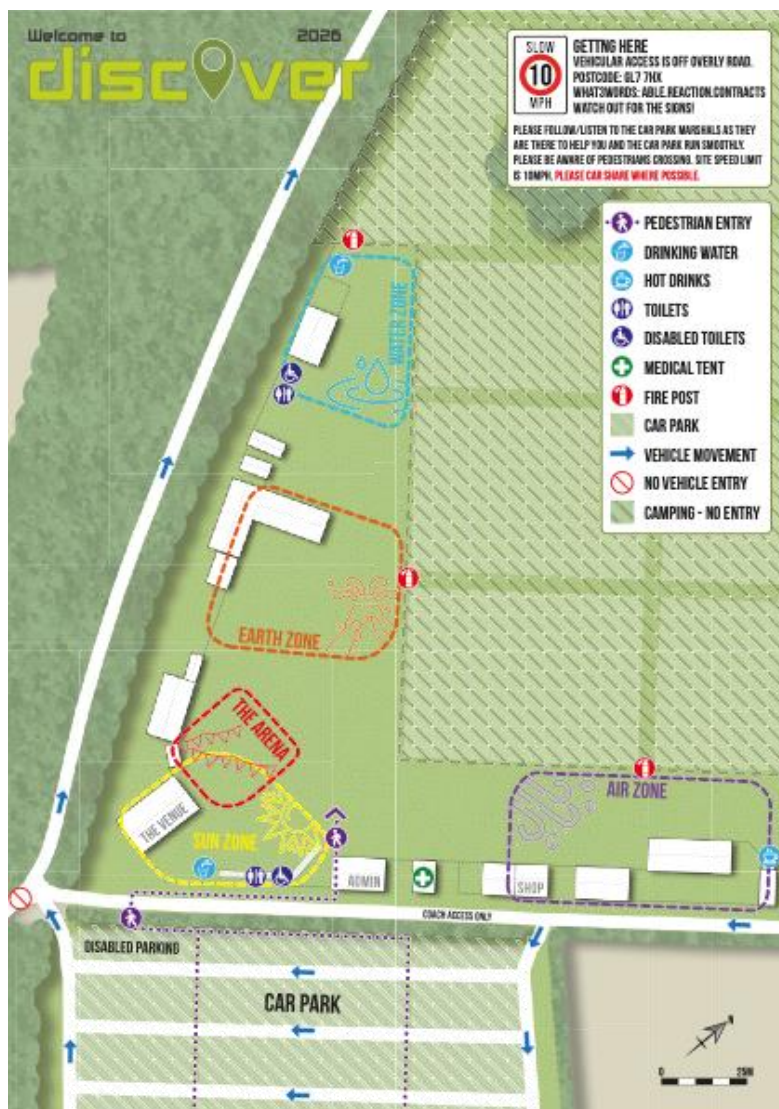

A full-resolution site map is available at s-e.org.uk/downloads



VERSION HISTORY

Version	Date	Author	Summary of changes
1.0	31 May 2026	Mark Spiller, Emma Spiller, Josh Foye	Initial release

GET IN TOUCH

admin@s-e.org.uk • s-e.org.uk
Site phone (emergencies only): 01285 505 404